

Artistic Skylights conform to and exceed test requirements of the following criteria: AAMA/WDMA/CSA 101/I.S.2/A440-17 (NAFS - North American Fenestration Standard / Specification for windows, doors and skylights)

Skylights are suitable for use on flat roofs only. Designed for mounting on 3"(75mm) or 4"(102mm) curbs with flashing (by others), The flexible design makes it easy to achieve larger daylight openings.



- Custom sizes are available upon request

Model G-P-CF-FF Available Sizes				Project:
Model #	Outside Curb Dimensions	Glazing Type	QTY	Contractor:
G-P-CF-FF-42	40" x 40" (1016mm x 1016 mm)			
G-P-CF-FF-52	49½" x 49½" (1251mm x 1251 mm)			
G-P-CF-FF-60	58" x 58" (1473mm x 1473 mm)			
G-P-CF-FF-72	70" x 70" (1778mm x 1778 mm)			
G-P-CF-FF-96	92½" x 92½" (2350mm x 2350mm)			
G-P-CF-FF CUST.				Architect:
G-P-CF-FF CUST.				Approved By:
Glass Glazing Available				Date:
Glass Glazing	Colour Code	Glass Glazing	Colour Code	
Clear/Low-E	- Low-E	Clear/Laminated	- Lami.	
Bronze/Low-E	- B/Low-E	Argon/Low-E	- Low-E/Arg	

Specifications:

Skylight shall be factory assembled Model No. \_\_\_\_\_ G-P-CF-FF as manufactured by Artistic Skylight Domes Ltd. Vaughan, Ontario. Glazing shall consist of sealed dual tempered glass of clear low-E over clear. The skylight shall consist of corrosion resistant extruded aluminum curb frame, 6063-T5 alloy, with heliarc welded corners. The skylight curb frame shall have an extruded aluminum vinyl thermal break, with high capacity, sloped condensation gutter and drainage to exterior. The retaining cap frame shall be extruded, mill finish, 6063-T5 aluminum alloy with heliarc welded corners. Ridge shall consist of double 2" (rafter of single 2") mill finish extruded aluminum channel and pressure plate of 6063-T5 alloy, with keyed in place Santoprene gaskets. Rafter spacing to be maximum 4'. Options include painted, anodized or powder coated finishes on aluminum.

SECTION-B

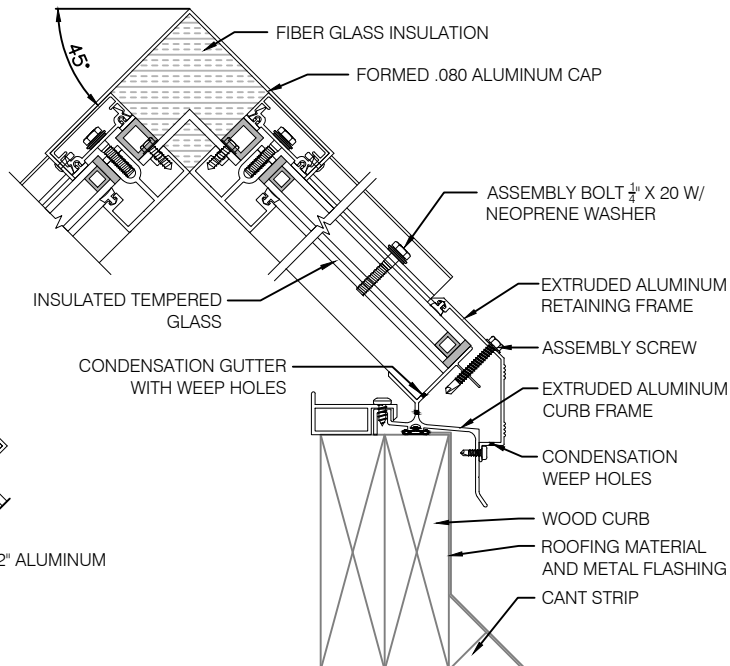

SECTION-A

